

2 - 2" INSULATION BOARD TO BE CLOSED CELL (36" WIDE), EXTRUDED POLYSTYRENE FOAM MEETING ASTM 578, TYPE VI, 40 PSI COMPRESSING STRENGTH (ASTM D1621) 0.1% MAX. WATER ABSORPTION (ASTM C272)

6" PEA STONE OR No. 8 AGGREGATE, MIN. 18"

CLEANOUTS LOCATED WITHIN A HARD SURFACE AREA MUST HAVE A CASTING. PLACE TOP FLUSH WITH SURFACE TO PREVENT A TRIPPING HAZARD. NO EXPANSION MATERIAL OR PVC PIPE AROUND CASTING, PLACE RELIEF SAW CUTS AT CASTING TO PREVENT RANDOM CRACKING

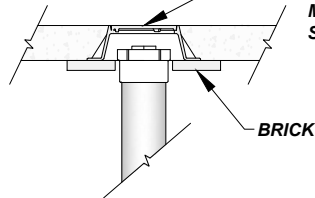

BRICK

CLEANOUT CASTING (NEENAH #3-4055 OR APPROVED EQUAL)

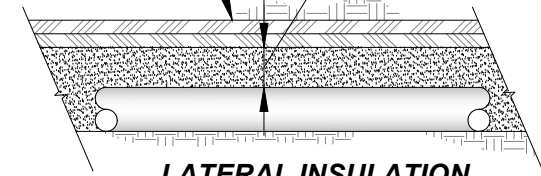

LATERAL INSULATION (LESS THAN 36" OF COVER)

INSTALL CLEANOUT 12" INSIDE THE RIGHT OF WAY IF CONNECTING TO AN EXISTING LATERAL, LOCATION MAY BE MODIFIED TO AVOID SIDEWALKS IF APPROVED

INSTALL CLEANOUT 12" OUTSIDE THE RIGHT OF WAY AND/OR UTILITY EASEMENT FOR NEWLY INSTALLED SANITARY SYSTEMS

THREADED CAP, SET FLUSH WITH FINISH GRADE

INSTALL LATERAL AT DEEPEST POSSIBLE DEPTH WITHIN ROW FROM SEWER MAIN TO CLEANOUT
6" SDR-35 PVC LATERAL AT A MINIMUM 0.60% SLOPE WITH 6" OF PEA STONE OR No. 8 AGGREGATE OVER THE LATERAL WITHIN RIGHT OF WAY. BACKFILL AND COMPACT PER CURRENT CITY STANDARDS

5.0' MINIMUM FROM BUILDING FOUNDATION IF NOT PLACED AT RIGHT OF WAY. CITY OF GOSHEN ENGINEERING DEPARTMENT TO APPROVE LOCATION OF CLEANOUT OUTSIDE THE ROW

CLEANOUT SIZE TO MATCH SERVICE LINE SIZE

45° OR 22.5° PVC FITTING AS REQUIRED

MAX. 12" OF EXISTING CLAY LATERAL

5.0' MINIMUM WITHIN ROW

12" MIN.

SEE DETAIL SW-403

CONNECTED TO EXISTING LATERAL WITH SHIELDED COUPLER. INSTALL A WATERTIGHT CAP IF LATERAL IS ONLY STUBBED FOR FUTURE CONNECTION, PLACE A 4" X 4" VERTICAL TIMBER PAINTED GREEN AT THE END OF THE LATERAL TO MARK LOCATION. EXTEND 24" ABOVE GROUND

6" X 6" X 6" DOUBLE SWEEP CLEANOUT

PLACE ON APPROVED COMPACTED NATIVE MATERIAL UNLESS UNSUITABLE, THEN PLACE 4" OF PEA STONE OR No. 8 AGGREGATE BEDDING UNDER LENGTH OF PIPE

SHIELDED FLEX COUPLER

FULLY SUPPORT LATERAL AND FLEX COUPLER WITH PEA STONE OR No. 8 AGREGGATE

EXISTING CLAY MAIN AND WYE

SEWER LATERAL REPLACEMENT AT EXISTING TAP

NOT TO SCALE